

Maximum Electrical Current:

22-16 A.W.G.: 19 amperes
 16-14 A.W.G.: 27 amperes
 12-10 A.W.G.: 48 amperes

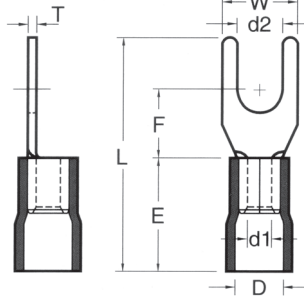

Maximum Electrical Rating:

75 °C (167 °F)
 600 volts

Insulation Material: Vinyl

Terminal Material: Copper (tin-plated)

WIRE RANGE A.W.G.	PART NUMBER	STUD SIZE	DIMENSIONS (inches/mm)								BULK QTY
			d2	W	F	L	E	D	d1	T	
22-16	GS-R6V	#6	0.146 3.7	0.252 6.4	0.256 6.5	0.827 21.0	0.394 10.0	0.157 4.0	0.067 1.7	0.030 0.75	1000
	GS-R8V	#8	0.169 4.3	0.283 7.2	0.256 6.5	0.827 21.0					1000
	GS-R10V	#10	0.209 5.3	0.374 9.5	0.256 6.5	0.827 21.0					1000
16-14	GS-B6V	#6	0.146 3.7	0.236 6.0	0.256 6.5	0.827 21.0	0.394 10.0	0.177 4.5	0.091 2.3	0.031 0.8	1000
	GS-B8V	#8	0.169 4.3	0.283 7.2	0.256 6.5	0.827 21.0					1000
	GS-B10V	#10	0.209 5.3	0.366 9.3	0.256 6.5	0.827 21.0					1000
12-10	GS-Y8V	#8	0.169 4.3	0.354 9.0	0.276 7.0	1.004 25.5	0.512 13.0	0.248 6.3	0.134 3.4	0.039 1.0	1000
	GS-Y10V	#10	0.209 5.3	0.354 9.0	0.276 7.0	1.004 25.5					1000

